

STANDARD FEATURES

PROFESSIONAL RANGE

COMPACT & LIGHTWEIGHT

MacGen provide their range in one of the most compact and lightweight packages. This provides reliable power with a low impact design to suit any application or site.

CEM CONTROLLER

The complete range of MacGen sets are supplied with our CEM Electronic controller / display panel.*

CANOPY

The MacGen weatherproof canopy covers the entire range of generators, providing full protection for the generator's internal parts and also ensures the highest levels of soundproofing to comply with all European standards.

* EXCLUDING MPG13 MODEL



ROUNDED CORNERS

The outer canopy incorporates rounded corners to add structural strength and also prevents corrosion through paint work damage. All sets are 1000+ hours sea salt spray tested.

FITTINGS

The full MacGen range come with high quality stainless steel hinges, protecting them from the elements for the lifetime of the product.

BUNDED BASES

MacGen generators come with fully banded bases incorporating 110% fluid containment and drainage bung.

MOBILITY

For ease of mobility our range of generators come complete with heavy duty forklift pockets and a central lifting point on top of the set.*

MPG 13-40 kVA

PROFESSIONAL SOUNDPROOF | 400 - 230V

POWERED BY 



Model shown is the MPG35

- 1. Radiator with pusher fan
- 2. Decanting filter
- 3. Oil sump extraction kit
- 4. Emergency Stop Button
- 5. Central lifting hook*
- 6. Inlet for power cables*

- 7. Hot protection fan and front radiator protection
- 8. Exhaust rain cap
- 9. External refuelling*
- 10. Forklift pocket



Model shown is the MPG13

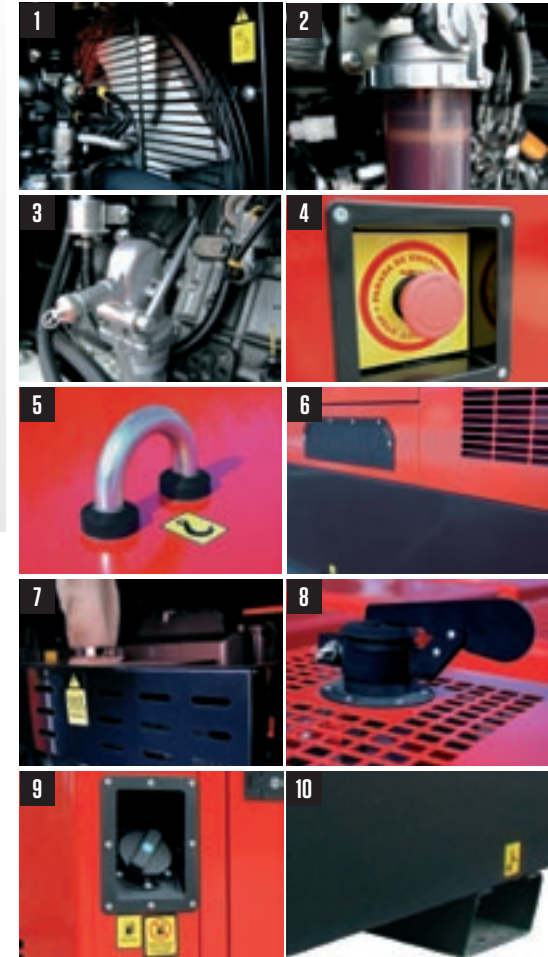

Images shown are from the MPG35 model

* EXCLUDING MPG13 MODEL

TECHNICAL SPECIFICATIONS | PROFESSIONAL RANGE

POWERED BY 

Model	MPG13	MPG20	MPG35	MPG40
Prime Output (kVA)	12.8	20	34	41
Standby Output (kVA)	13.8	22	37	45
Frequency (Hz)	50			
Available Voltages (V)	400/230			
Sound Level @ 7 metre dB (A)	59	57	63	63
Alternator	SELF-EXCITED BRUSHLESS WITH AVR			
Speed Governor	MECHANICAL			
Control Panel Type	M6	CEM	CEM	CEM
Alternator Output (Amps/Phase)	22	29	45	59
Engine Model	3TNV88	4TNV84TGGE	4TNV98GGEH	4TNV98TGGEH
Prime Power (kW)	12.3	18	27	36
No. of Cylinders (T) Turbo	3	4(T)	4	4(T)
Electrical System (V)	12			
Fuel Tank Capacity (l)	22	100	100	100
50% Load Fuel Consumption (l)	2	2.99	4.6	5.49
Run time @ 50% Load (hrs)	11	33.44	21.73	18.21
Overall Length (mm)	1475	2100	2100	2100
Overall Width (mm)	750	975	975	975
Canopy Height (mm)	1110	1349	1349	1349
Weight (kg)	691	885	950	960